

RS-1

INFINITER®



Laser Cutting Guide

**Infiniter LASER Cutting Guide Miter Saw Operation:**

1. Draw a pencil line or mark on the workpiece to show where the cut will be made. Be aware of which side of the line you want to cut.
2. Place the workpiece on the table against the fence in the cutting area with you pencil line near the center of the table.
3. Keep hands away from the saw blade. Turn the tool on with the saw in the "up" position. The laser line will appear on the workpiece. Keep hands away from the saw blade and slide the workpiece until the pencil line or mark is to the immediate right of the laser line. Turn tool off then release workpiece.
4. Clamp workpiece to table.

**Alignment**

1. Align laser line to mark with blade in upper-most position.
2. Due to the position of the RS1 with respect to the blade, the laser line will shift slightly from right to left as the blade is lowered to the workpiece. The laser line will line-up with the left side of the blade when the blade teeth are approximately 5 inches from the top surface of the workpiece.

Practice making different styles of cuts in different materials and thicknesses in order to become comfortable with the Laser cutting Guide operation.

**Replacing the batteries:**

To change the batteries, use a #0 Phillips screwdriver to remove the screws on the bottom base (slightly beveled black surface) of the guide. After replacing the batteries be sure to re-align the top and hand tighten the screws evenly.

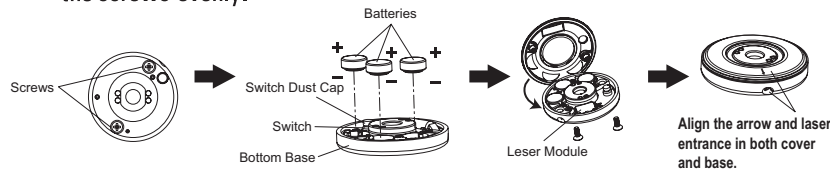

RS-1

INFINITER®

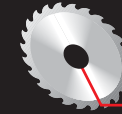

Laser Cutting Guide

**Infiniter LASER Cutting Guide Mounting Instructions:**

1. Be sure your saw is unplugged or otherwise removed from its power source.
2. Remove the bolt and outer blade washer that is original to your saw. Note: it may be necessary to remove the guide assembly to gain access to the bolt. (Fig.1)
3. Mount the LASER Cutting Guide (flat surface to the blade) in place of the just-removed outer blade washer. (Fig.2)
4. Note: store the manufacturer's original blade washer in a safe place for re-use, if necessary.
5. Re-palce and tighten the bolt securely. Note: if it was necessary to move the guard assembly be sure to restore it to it's original secure operating position.
6. Operate the saw according to the manufacturer's instructions.
7. Class IIIa Laser - **DANGER** - Always avoid direct eye contact with the LASER beam.

